

TYPES OF

EXHAUST

Fans & Selection



Important



Subscribe

YOUTUBE ONLINE TRAINING CHANNEL

Prepared By:
MUJEEB KHAN
B.TECH MECHANICAL ENGINEER

Types Of Exhaust Fans



Sidewall Propeller



Centrifugal Upblast



Sidewall Propeller



Hood Propeller Fan



Centrifugal Inline



Centrifugal Roof Mounted



Utility Centrifugal



Commercial Centrifugal

Exhaust Fan Selection

Selection Parameter :

- Air Flow = CFM or LPS
- Static Pressure = Inch wg or Pascal

Example :

Utility Centrifugal Exhaust Fan

- AIR FLOW = 1500 CFM
- STATIC PRESSURE = 1.5 l.wg



Exhaust Fan Selection

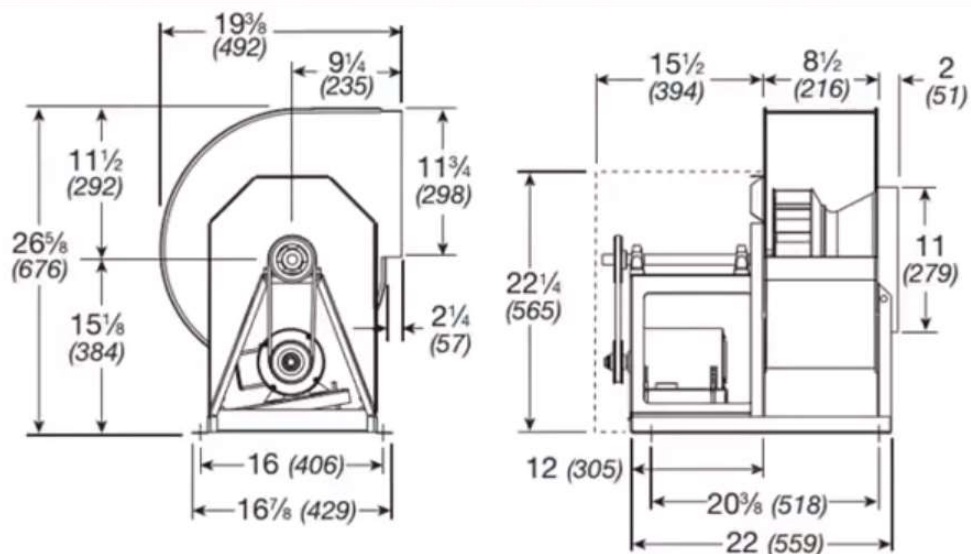

Wheel Diameter = $10\frac{5}{8}$ (270)
 Shaft Diameter = $\frac{3}{4}$ (19)
 Outlet Area = 0.705 ft^2 (0.065 m^2)
 ^Approximate Unit Weight = 130 lb. (59 kg)

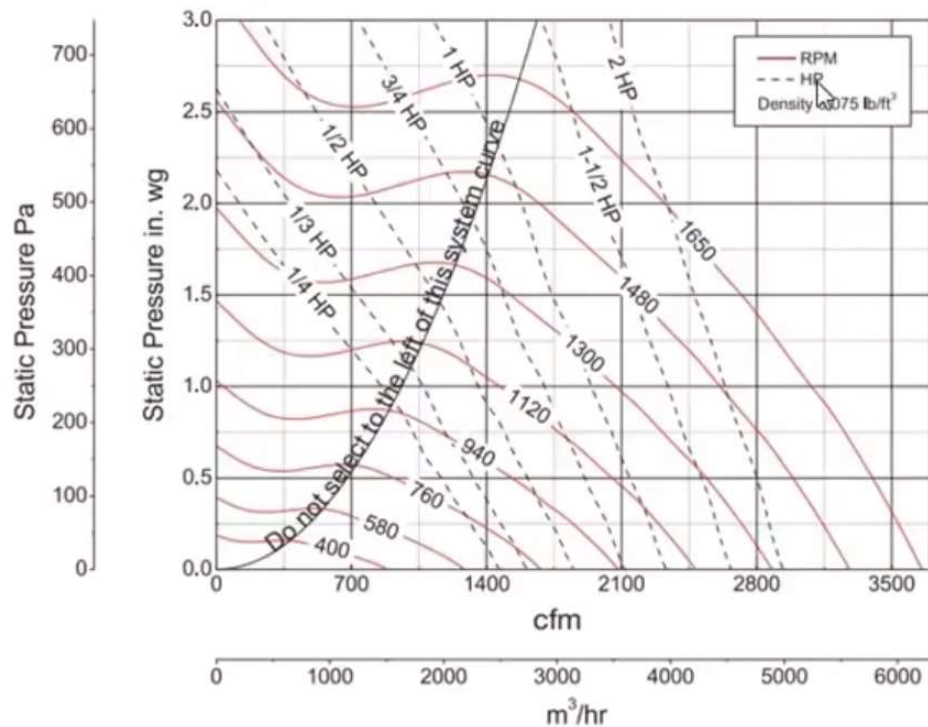

Exhaust Fan Selection

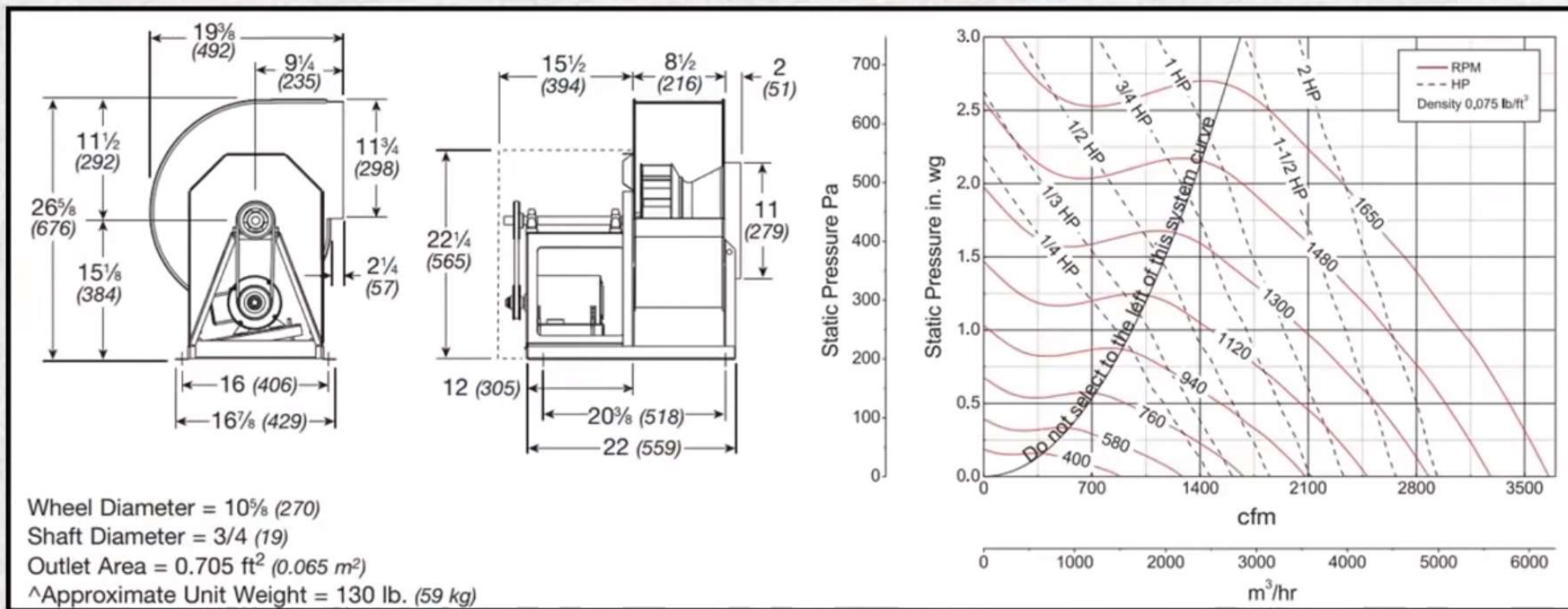

- Air Flow = 1500 CFM
- Static Pressure = 1.5 in.wg

Exhaust Fan Selection

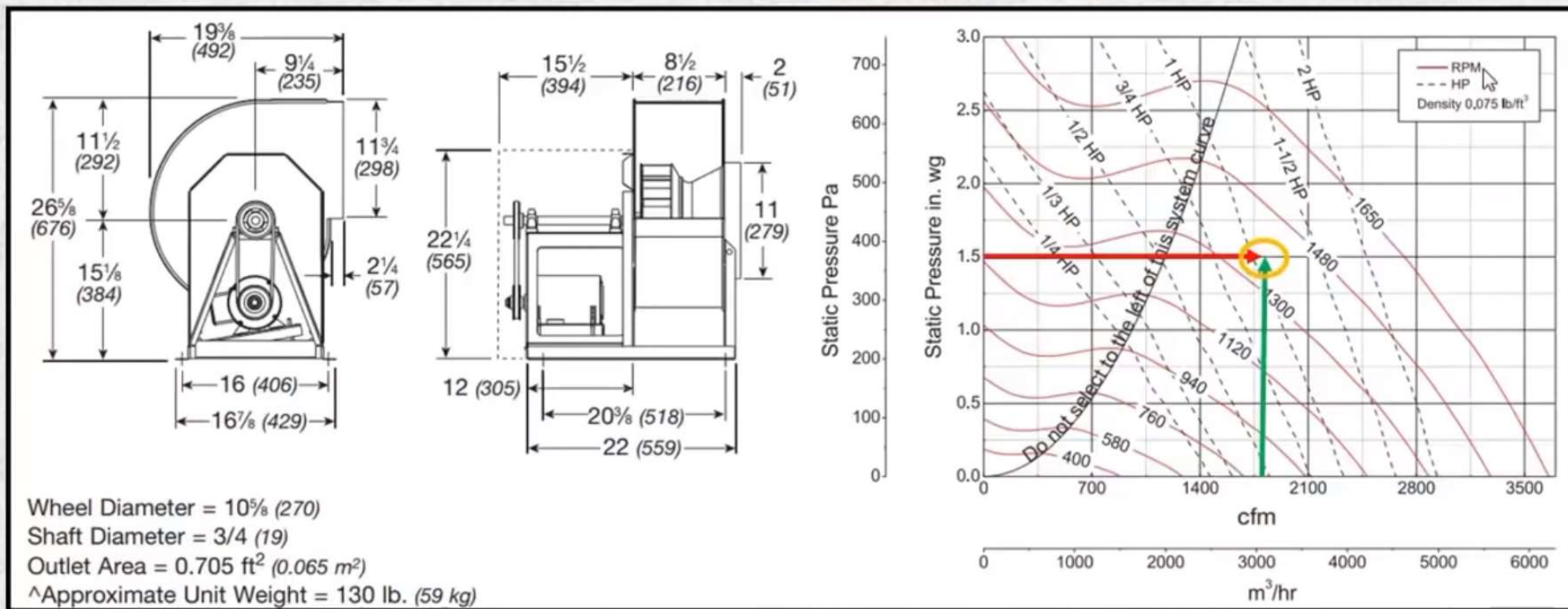

- Air Flow = 1500 CFM
- Static Pressure = 1.5 In.wg

Exhaust Fan Selection

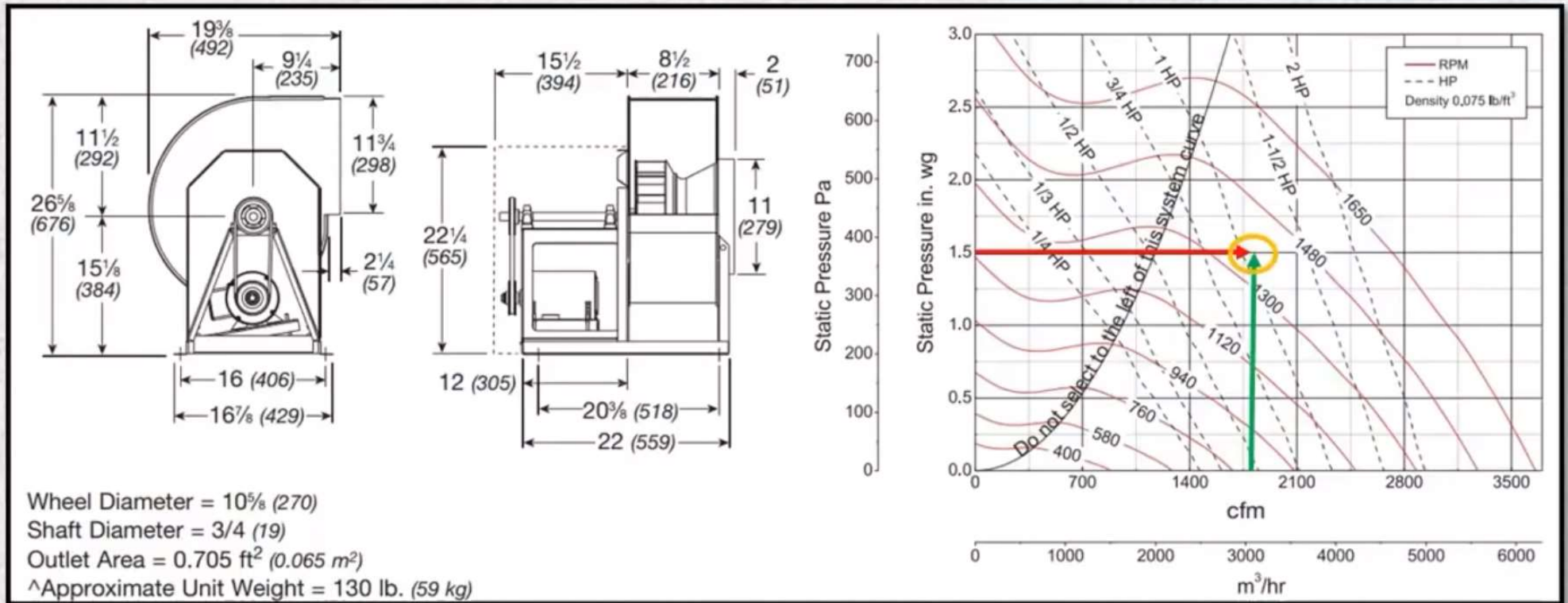

<input type="checkbox"/> Air Flow	= 1500 CFM	<input type="checkbox"/> Horse Power	= 1.5 HP
<input type="checkbox"/> Static Pressure	= 1.5 In.wg	<input type="checkbox"/> Speed	= 1480 RPM